

AUTHORITY:
 THIS PLAN IS BASED ON THE TYPE DESIGN OF WORKSHOP FOR GOVT. POLYTECHNIC DRAWING NO. T-EDU-2993-X, DRAWING NO. 1.0 DATED 23/7/88 WHOSE LINE PLAN IS APPROVED BY THE SCRUTINISING COMMITTEE DURING THE MEETING HELD ON 02.08.88 & AS COMMUNICATED BY LETTER NO. 905-10377/CS/27 D-DIGS-1 DATED 14.08.88 BY THE GOVT.

NOTES:
 1. ANY DISCREPANCY NOTICED IN THIS DRAWING SHALL BE COMMUNICATED TO THIS OFFICE.
 2. ALL DIMENSIONS ARE IN METRE UNLESS OTHERWISE SPECIFIED.
 3. THE FINISHED FLOOR LEVEL OF THE TOILET BLOCK SHALL BE SUNNED BY 15MM THAN THE GENERAL FINISHED FLOOR LEVEL AND THAT OF W.C. & BATH SHALL BE SUNNED BY 16MM THAN THAT OF FINISHED TOILET FLOOR LEVEL.
 4. FOR THE SPECIFICATIONS & SCHEDULE OF OPENINGS, PLEASE REFER DRAWING NO. 10 OF THE DOOR & WINDOW SIZES AND INCLUDING 6 ONLY WRITTEN DIMENSIONS SHALL BE FOLLOWED.
 5. ALL DOOR OPENING HEIGHTS ARE FROM THE FINISHED FLOOR LEVEL.
 6. THE HEIGHT OF INTERNAL WALLS AND PARTITIONS OF THE TOILET BLOCK SHALL BE 2.20M.
 7. AUTO DOOR CLOSERS SHALL BE PROVIDED AT THE MAIN DOORS OF TOILET BLOCKS.
 8. CONCRETE BAND SHALL BE PROVIDED FOR ALL THE WALLS AND PARTITIONS OF THE TOILET FOR ANTI-CRACKING PURPOSE.
 9. FOR INTERNAL LAYOUT OF THE TOILET FOR ANTI-CRACKING PURPOSE, REFER THE DETAIL DRAWINGS.
 10. TILES, WASH BASINS, URINALS, FITTINGS AND FIXTURES SHALL BE GOT APPROVED FROM THE DY. CHIEF ARCHITECT, A.P.O.
 11. PLINTH SHALL BE GOT APPROVED BY THE LOCAL AUTHORITY IN CONSULTATION WITH THE DY. CHIEF ARCHITECT, A.P.O.

NO.	DATE	BY	CONTENTS
1			
2			
3			
4			
5			
6			
7			
8			
9			
10			
11			
12			
13			
14			
15			
16			
17			
18			
19			
20			
21			
22			
23			
24			
25			
26			
27			
28			
29			
30			

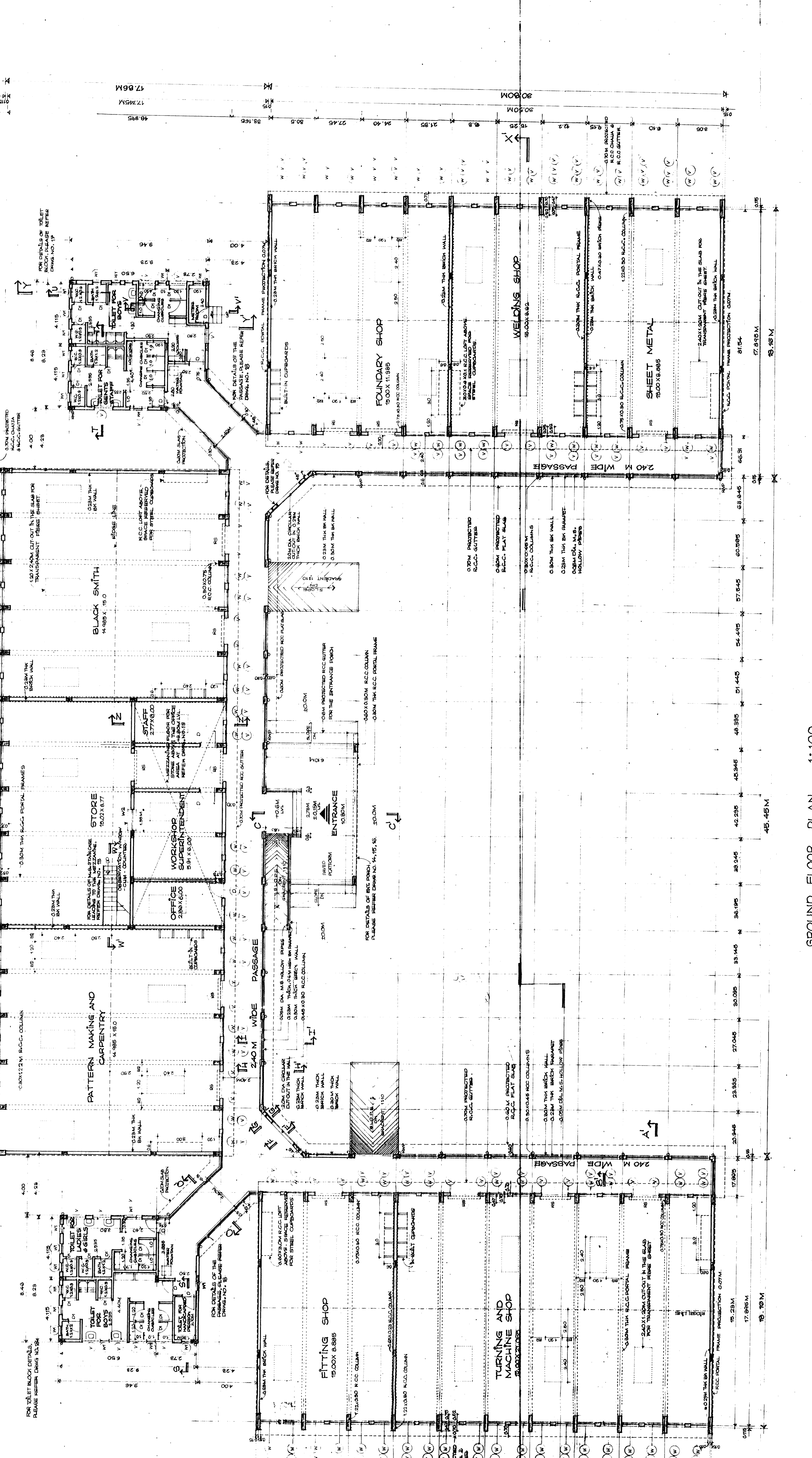

WORKING FLOOR PLAN
 SCALE: 1:100
 DRAWING NO. JLS (4) 9/71
 DATE: 28/05/84
 DESIGNED BY: RAJAGANESH
 CHECKED BY: RAJAGANESH
 DRAWING NO. 12

OFFICE OF THE DY. CHIEF ARCHITECT, P.W. REGION, AURANGABAD.
 P.S. BAJAJANT, DY. CHIEF ARCHITECT, CA/80/7874
 PROPOSED WORKSHOP BUILDING FOR GOVT. ENGINEERING COLLEGE AT JALGAON.